

# 丸太型枠 (NR2-2.0型) 標準構造図

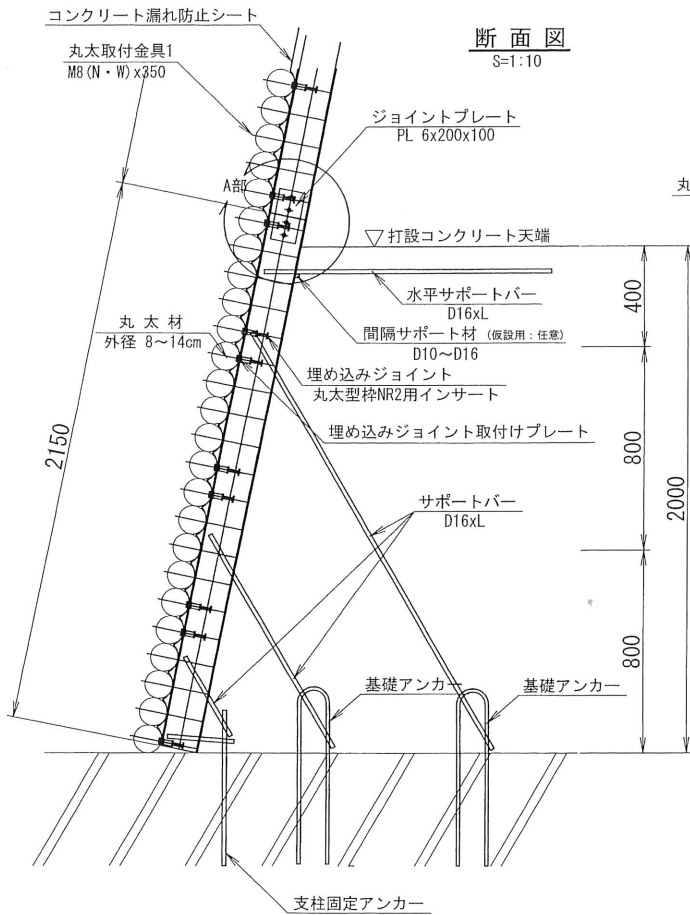

**A部詳細図**  
S=1:5

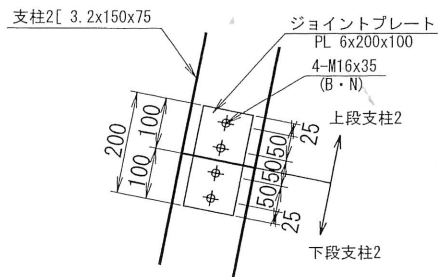

**正面図**  
S=1:5

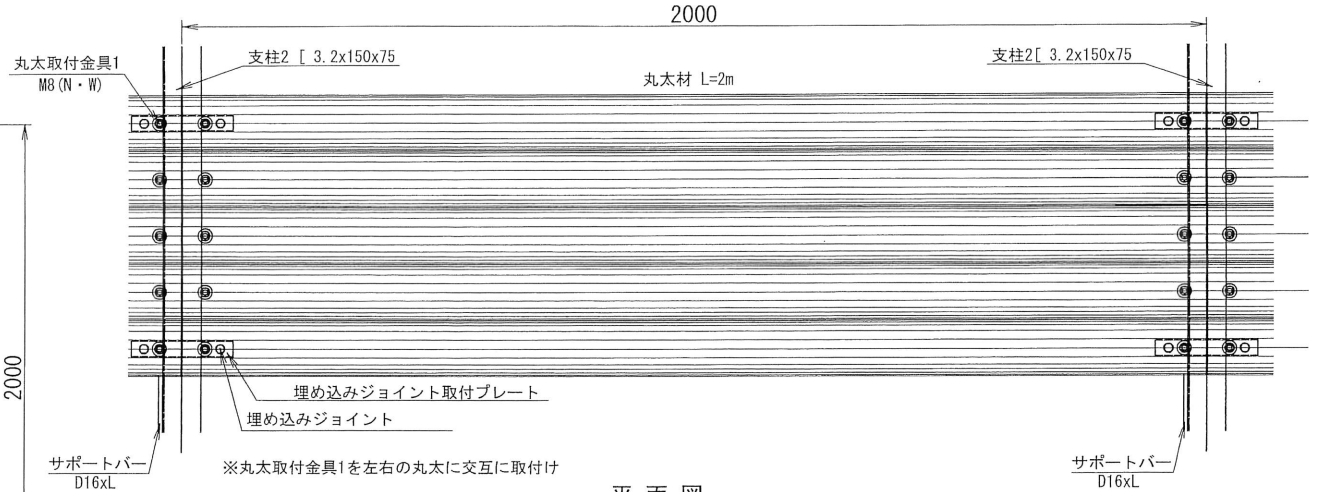

**平面図**  
S=1:5

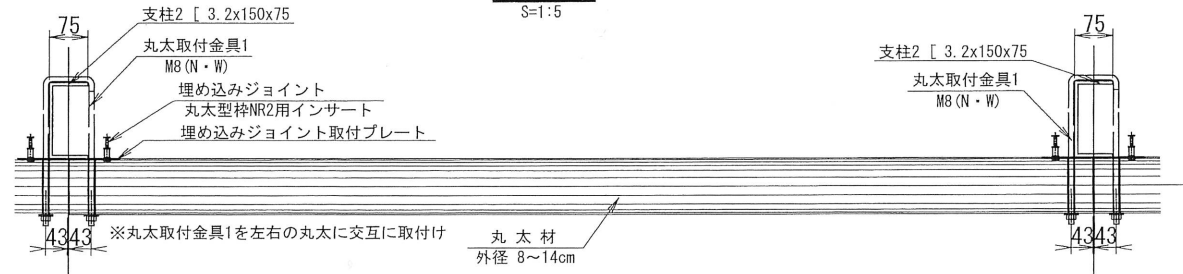

**丸太材取付部 詳細図**  
S=1:5

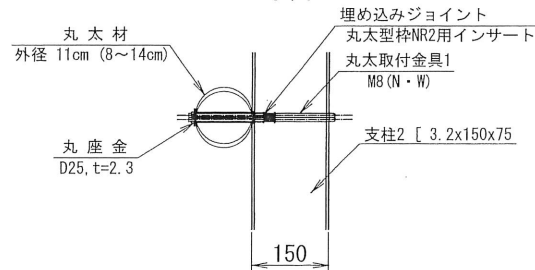

**埋め込みジョイント  
取付けプレート詳細図**  
S=1:5

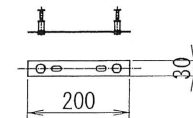

# 丸太型枠 (NR2-2.0型) 取替時標準構造図

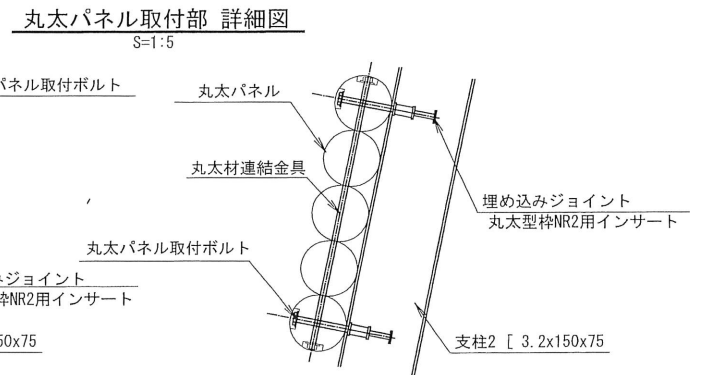
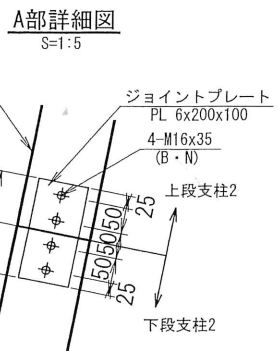
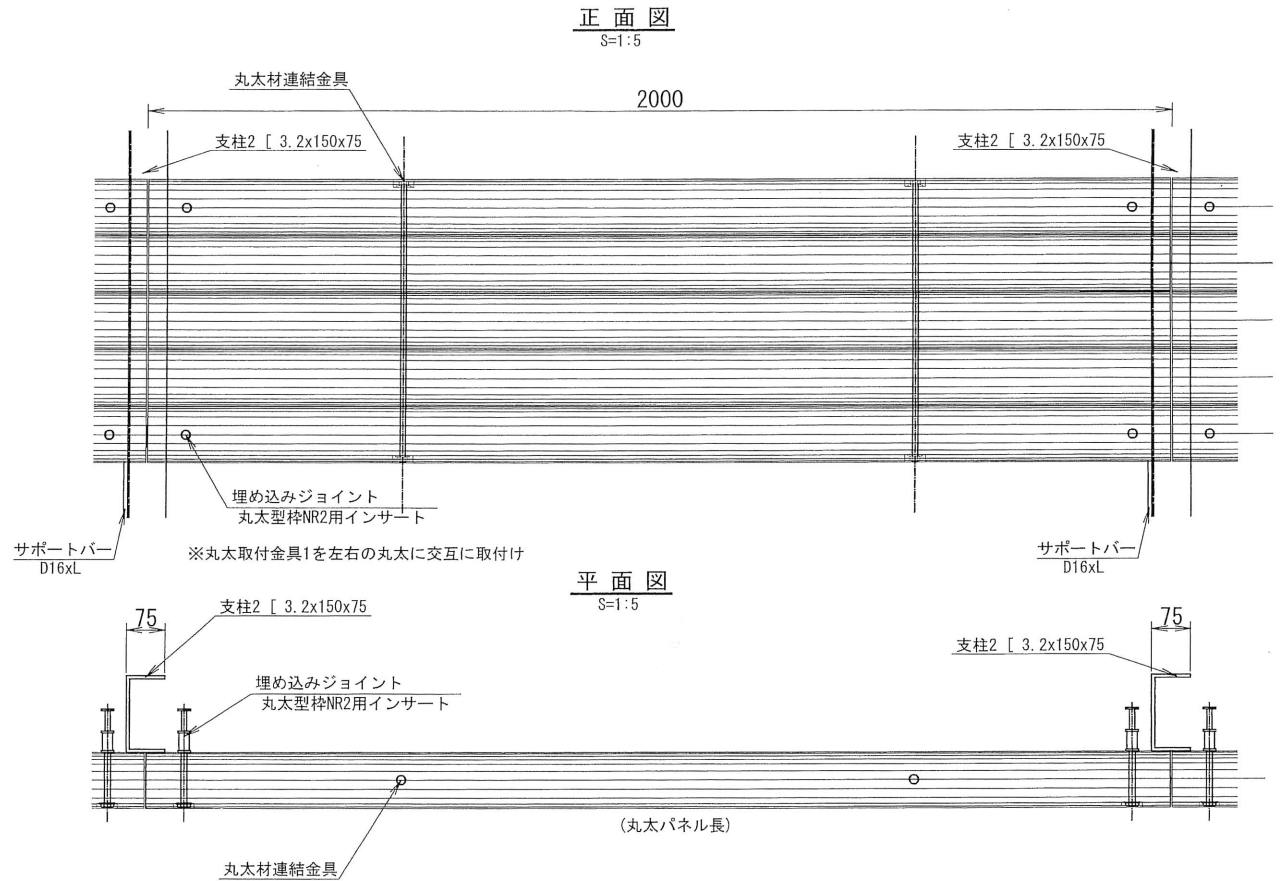
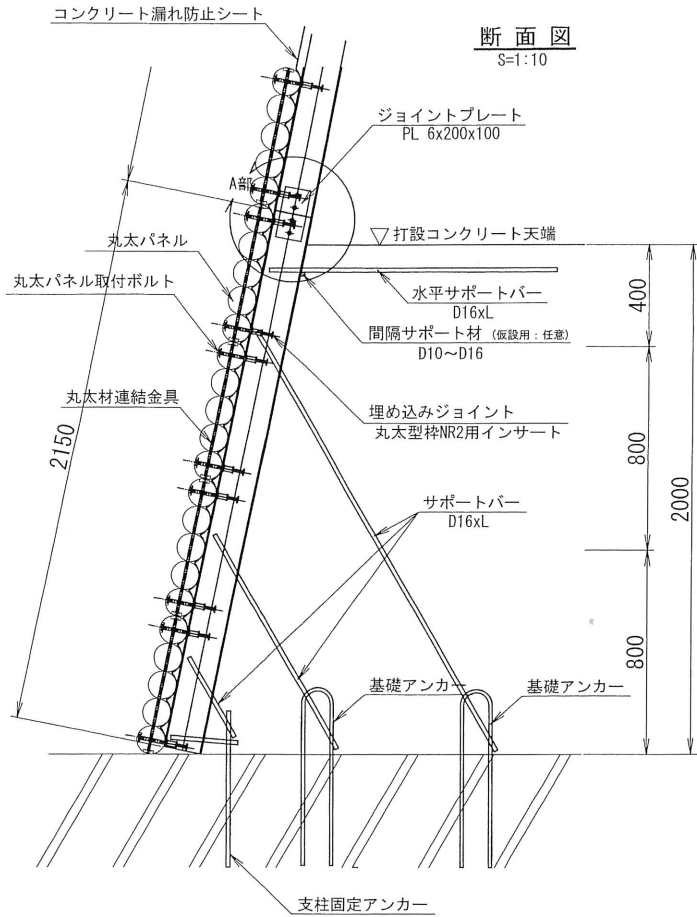

# 丸太型枠 (NR2-1.5型) 標準構造図

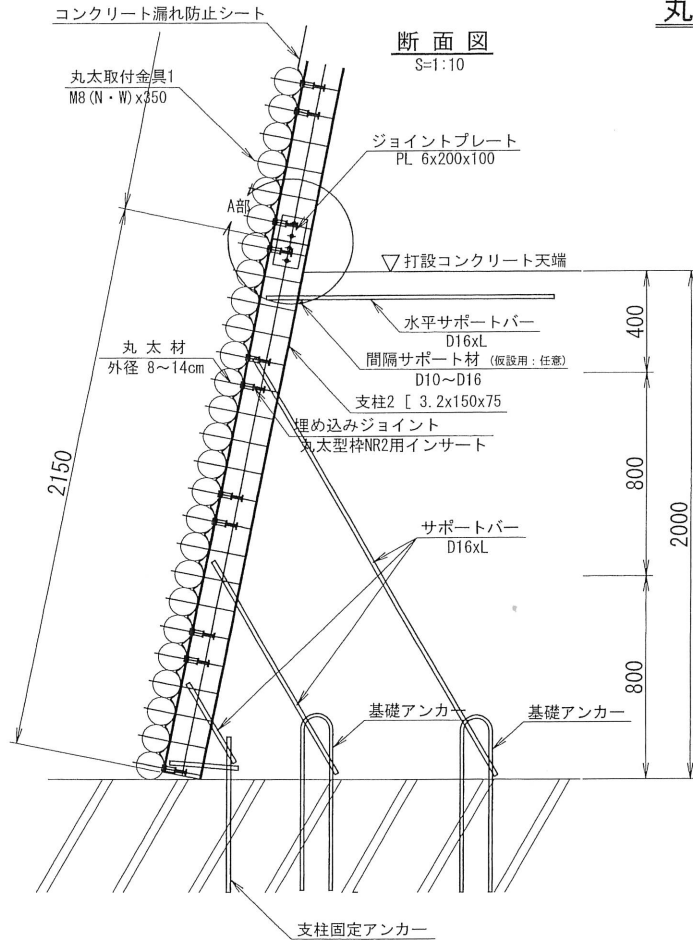

A部詳細図  
S=1:5

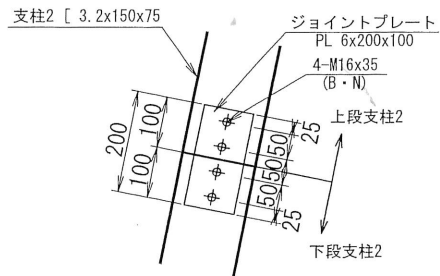

正面図  
S=1:10

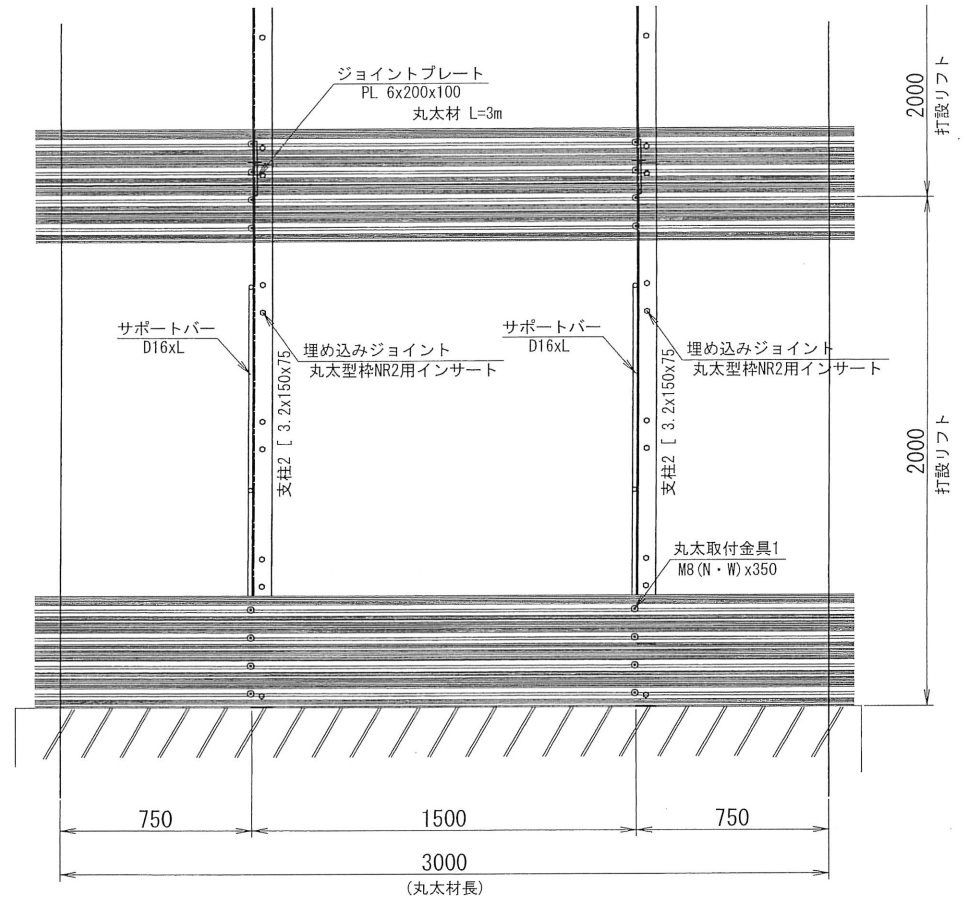

丸太材取付部 詳細図  
S=1:5

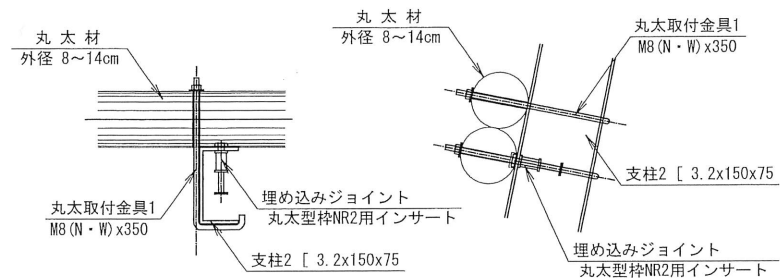

# 丸太型枠 (NR2-1.5型) 取替時標準構造図

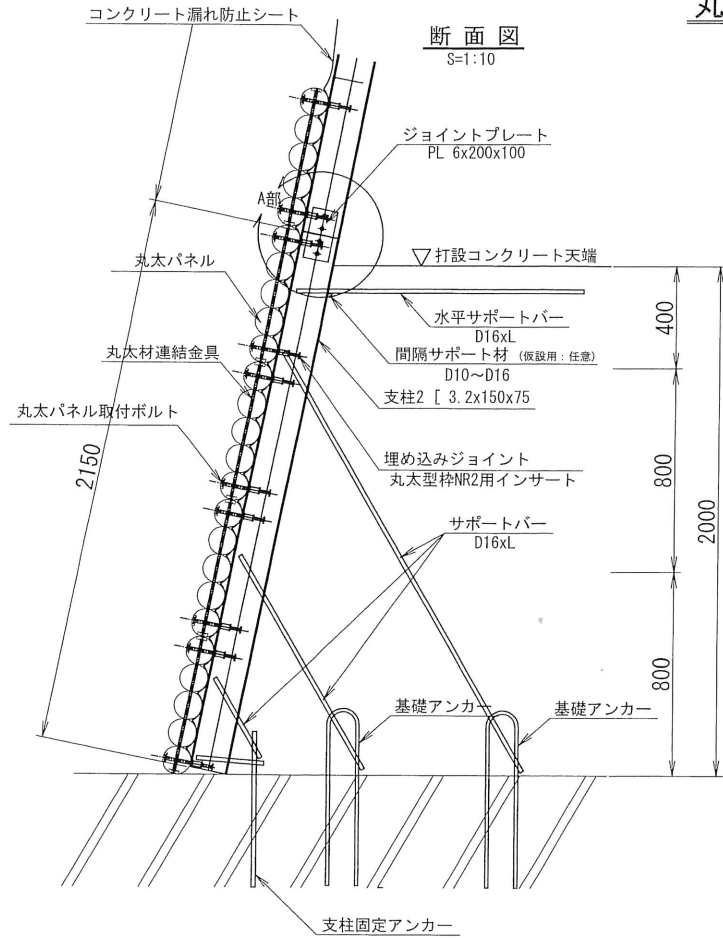

**A部詳細図**  
S=1:5

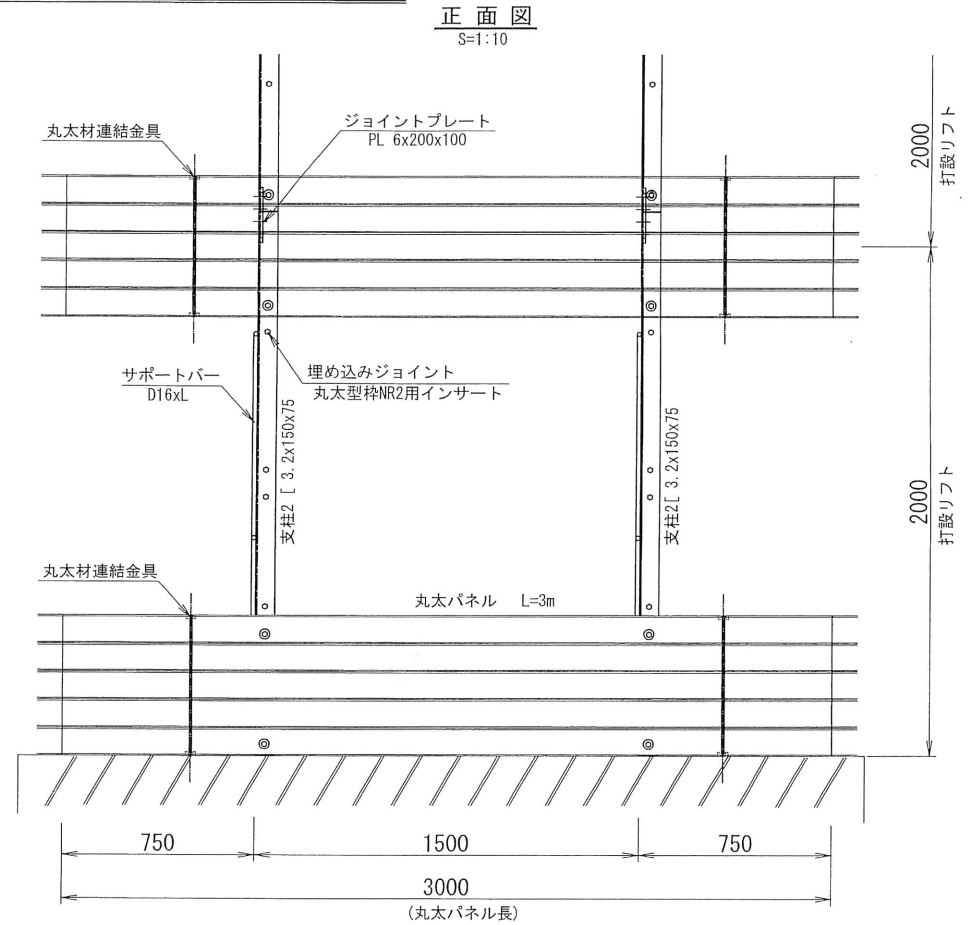
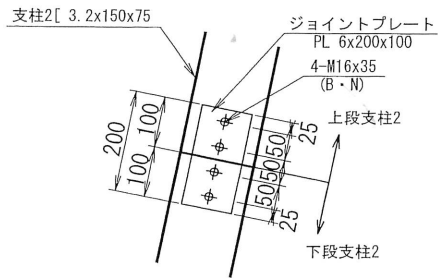

**丸太パネル取付部 詳細図**  
S=1:5

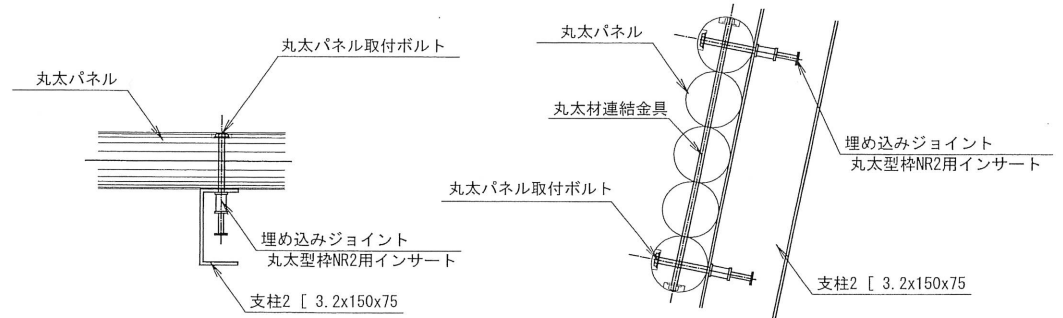

# 丸太型枠 (NR1-1.5型) 標準構造図

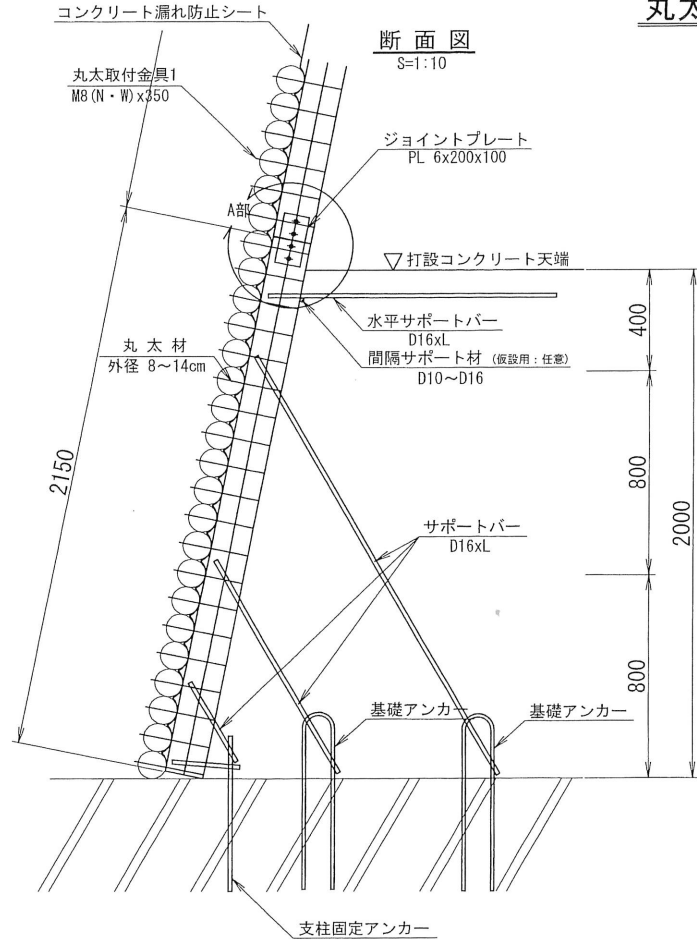

A部詳細図  
S=1:5

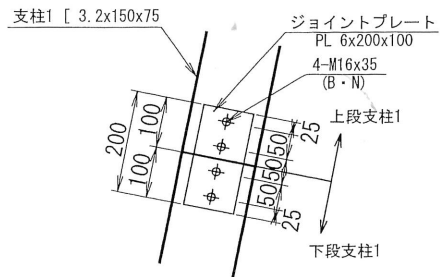

正面図  
S=1:10

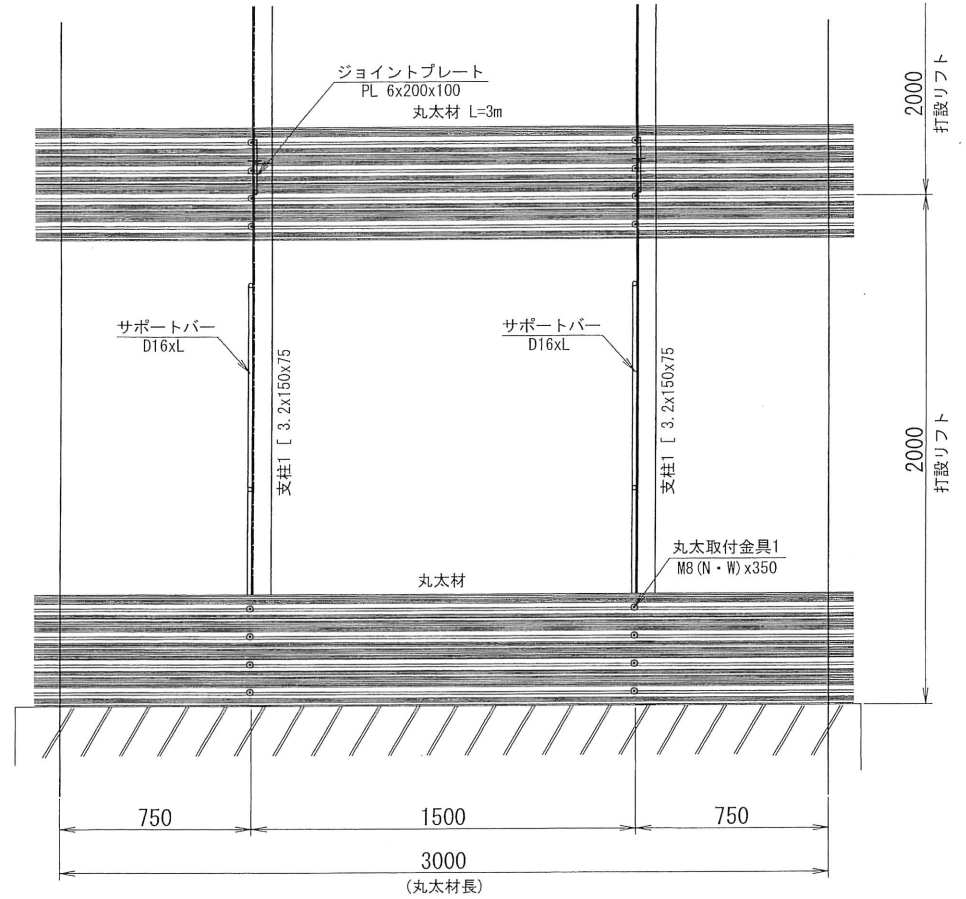

丸太材取付部 詳細図  
S=1:5

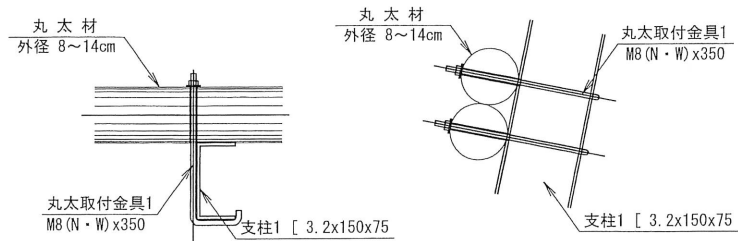

# 丸太型枠 (NR1-2.0型) 標準構造図

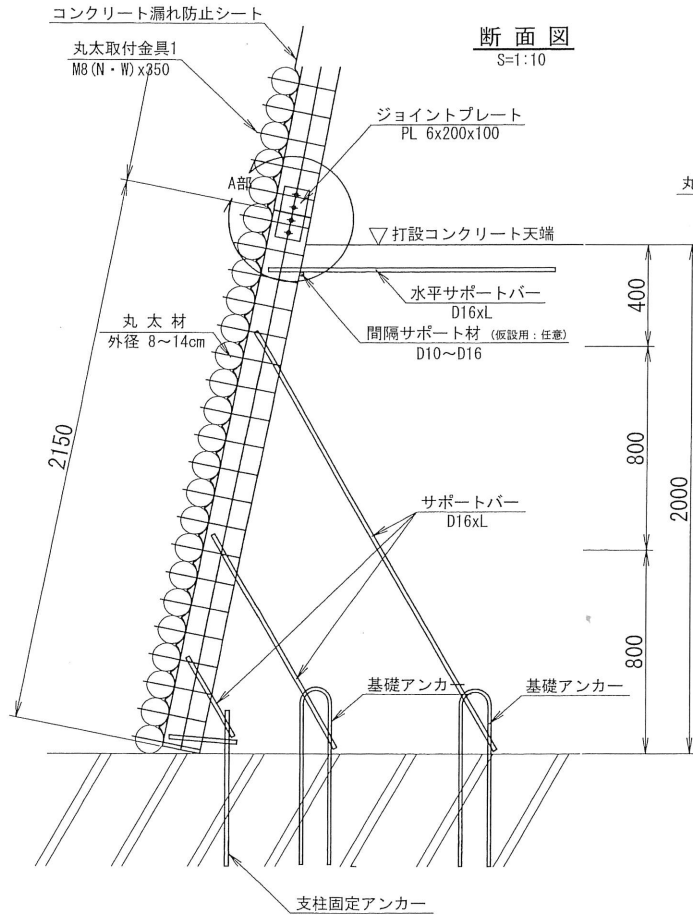

正面図  
S=1:5

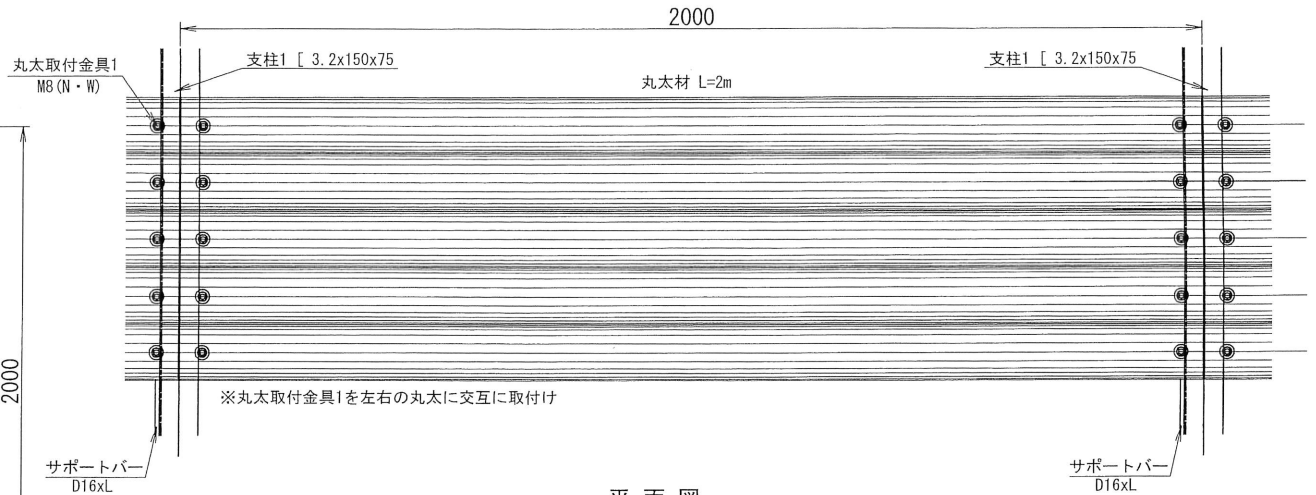

平面図  
S=1:5

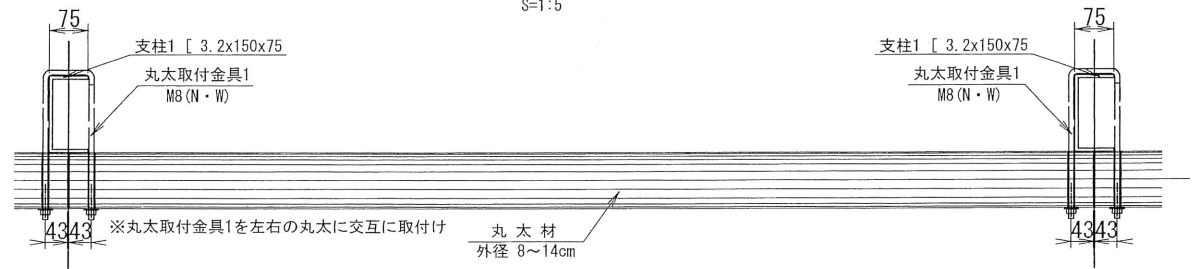

A部詳細図  
S=1:5

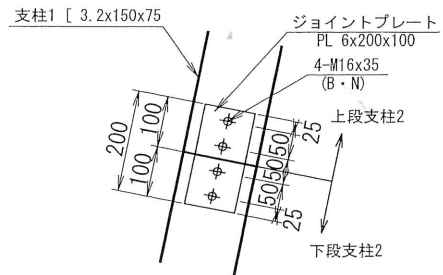

丸太材取付部 詳細図  
S=1:5

